

Print Head Installation



1. Turn Power to Printer On



2. Open Front Cover

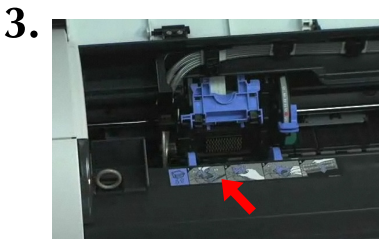

3. Follow Instruction on Label to open Print Head housing. (Blue Plastic)



4. Remove Print Head from packaging and remove all Orange Plastic Covers



5. Seat Print Head into machine with circuit board to back as shown on label in step 3



6. Close Blue Plastic Covers on Print Head Shuttle and close top machine cover.